

# SCHEDULE "A"



**CITY OF NANAIMO  
PRELIMINARY LAYOUT  
ACCEPTANCE**

*2015-MAY-06* *Norm Manser*  
Date Approved By  
*2016-MAY-06* Plan 14499  
Expiry Date

Notes:  
Variance for Lot 18 building setbacks.  
Variance for frontage on Lots 15 & 16  
Variance for depth on Lot 3

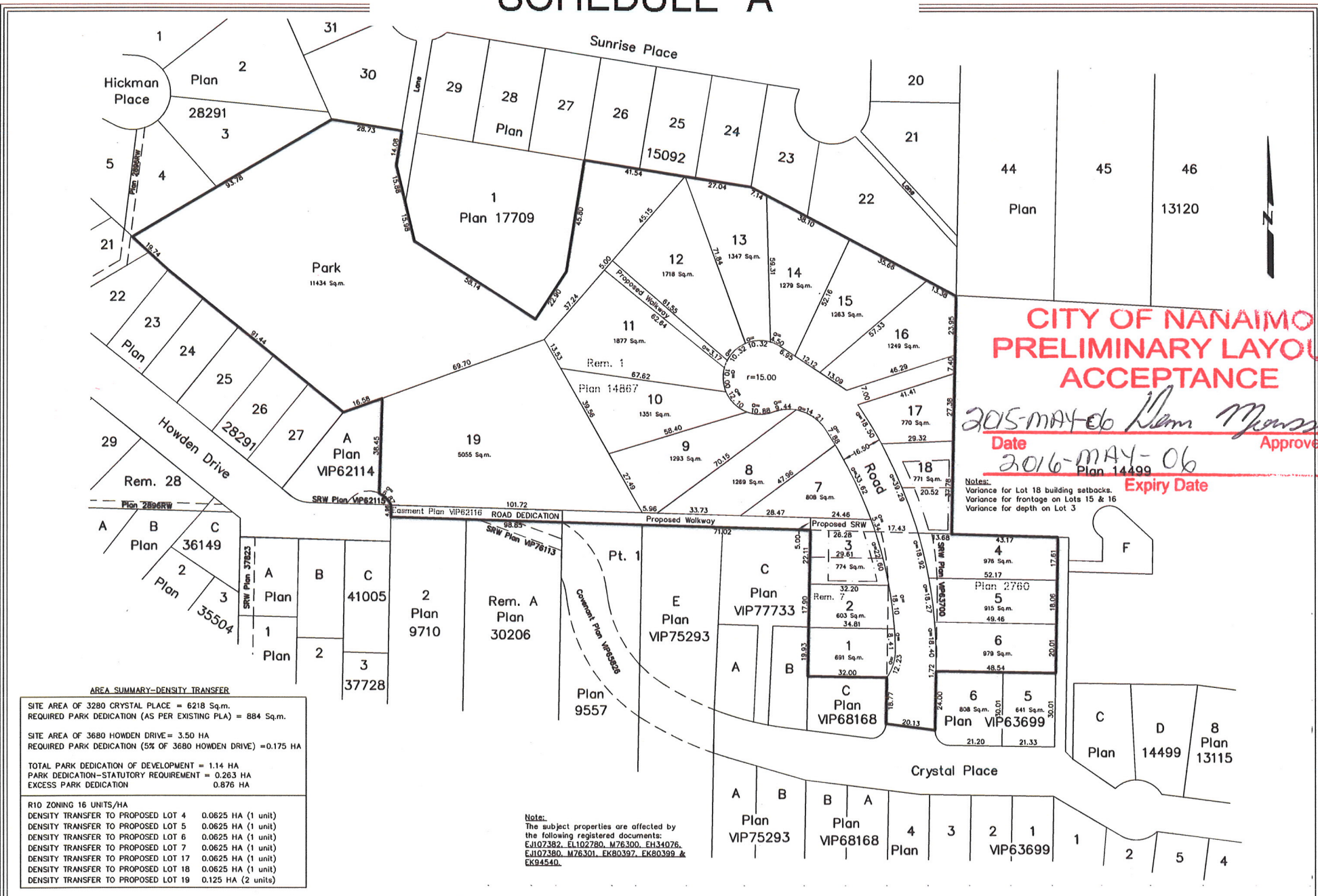

**AREA SUMMARY-DENSITY TRANSFER**

SITE AREA OF 3280 CRYSTAL PLACE = 6218 Sq.m.  
REQUIRED PARK DEDICATION (AS PER EXISTING PLA) = 884 Sq.m.

SITE AREA OF 3680 HOWDEN DRIVE = 3.50 HA  
REQUIRED PARK DEDICATION (5% OF 3680 HOWDEN DRIVE) = 0.175 HA

TOTAL PARK DEDICATION OF DEVELOPMENT = 1.14 HA  
PARK DEDICATION-STATUTORY REQUIREMENT = 0.263 HA  
EXCESS PARK DEDICATION = 0.876 HA

R10 ZONING 16 UNITS/HA

DENSITY TRANSFER TO PROPOSED LOT 4	0.0625 HA (1 unit)
DENSITY TRANSFER TO PROPOSED LOT 5	0.0625 HA (1 unit)
DENSITY TRANSFER TO PROPOSED LOT 6	0.0625 HA (1 unit)
DENSITY TRANSFER TO PROPOSED LOT 7	0.0625 HA (1 unit)
DENSITY TRANSFER TO PROPOSED LOT 17	0.0625 HA (1 unit)
DENSITY TRANSFER TO PROPOSED LOT 18	0.0625 HA (1 unit)
DENSITY TRANSFER TO PROPOSED LOT 19	0.125 HA (2 units)

Note:  
The subject properties are affected by the following registered documents:  
EJ107382, EJ102780, M76300, EJ34076, EJ107380, M76301, EK80397, EK80399 & EK94540.

Plan showing proposed subdivision of:  
Rem. Lot 1, District Lot 17, Wellington District, Plan 14867 &  
Rem. Lot 7, Section 5, Wellington District, Plan 2760.

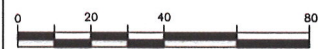

Scale 1:1000  
Distances shown are in metres.

Date:	Revision:
November 20, 2014	First Issue
November 29, 2014	Lot depths 3 & 18 include remainder within bold outlines
December 22, 2014	Revise lot layout
December 29, 2014	Area Summary
February 13, 2015	Revise Area Summary-Density Transfer Table
April 28, 2015	Reduce cul-de-sac radius to 15m

Certified correct this 28th day of April, 2015.

Turner & land surveying

Client: KSG Consulting and Jagots Holdings  
File: 14-130  
Scale: 1:1000  
Date: April 28th, 2015  
Drawn by: RJT

(This document is not valid unless originally signed and sealed.)  
B.C.L.S.  
250.753.9778  
605 Comox Road  
Nanaimo, BC V9R 3J4